

# MOON & PLAYBOY

VENUE

LAS VEGAS

USA



When the Palms Casino Resort first opened in 2001 it offered visitors to Sin City a very different take to the usual Las Vegas extravaganza-destinations. Set back from the strip it eschewed the trend for themed hotels in favour of a cleaner, more stylish approach. At the same time, Palms raised the bar for Casino clubbing by introducing super-clubs Rain and Ghostbar to the top of its 42-story tower – both created and operated by N9NE group entrepreneurs Michael Morton and Scott DeGraff. So successful were these venues that when Palms owner George Maloof decided to embark on an ambitious \$650 million expansion to his popular resort, including the creation of a second Fantasy Tower, he once again called in Morton & DeGraff to supply two new top-quality clubs. Enter Moon and Playboy. Stepping out of the lift, which shoots guests to the 53rd floor of the resort's new tower, Moon makes a stunning first impression. Guests are greeted by a series of glowing tiles and shimmering chain curtains that give the whole venue a stylish, subtly space-

aged aesthetic. Over 1,700 LEDs, both Color Kinetics and custom made fixtures from Las Vegas-based CES, are installed throughout the club to give it a distinctive celestial glow.

Unlike the 30,000-square foot Rain, Moon is a much more intimate environment, as lead designer Scott DeGraff points out: "As a boutique night club, Moon lacks the size of Rain or other Vegas mega-clubs, but it is like nothing else on the planet." Indeed, Moon's top-floor vantage point not only gives guests a spectacular view of the Las Vegas strip, but allowed the design team to incorporate a retractable roof which, when opened – exposes revelers to the stars above. "There are indoor venues and outdoor venues," notes co-owner Michael Morton, "but nobody in Las Vegas has ever done this before."

Unusually for a Vegas install, the creation of Moon and the Playboy lounge downstairs took nearly 19 months from inception to opening, but with its position at the top of the tower and a dedication to providing the best quality possible, a huge amount of

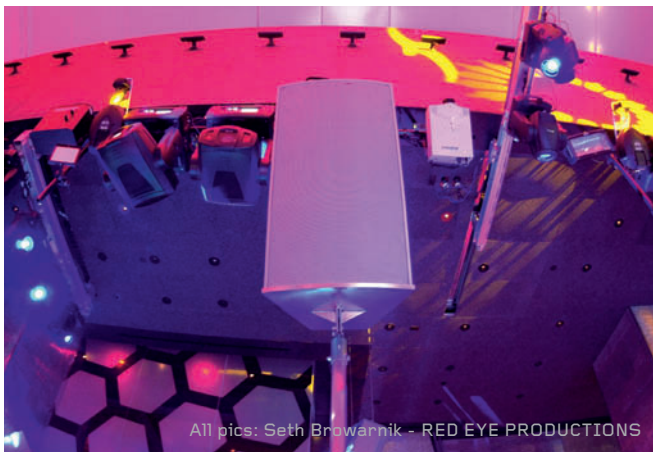

All pics: Seth Brownnik - RED EYE PRODUCTIONS

## TECHNICAL INFORMATION

### LIGHTING

MAIN ROOM: 18 x Martin Mac 250 Krypton; 6 x Martin Mac 250 Wash; 16 x Martin Mx-10 Extreme; 2 x Martin Atomic 3000; 8 x High End DL2; 1500 x "Color Kinetics C.E.S." RGB LED fixtures; 2 x Laser Designs Fiber Optic Fan; 2 x Laser Designs YAG Lasers 5W; 1 x Laser Designs WL Laser; 3 x Robe Robe 150AT. VIDEO: 1 x Brash Brash Media Server; 6 x Christie 5000 Lumen Projectors; 2 x LG "50" Plasma TV"; 1 x Pioneer DVJ; 11 x Bosch cameras; 1 x Ediol V4 video mixer. PLAYBOY: 16 x Broadsign media server; 64 x LG LCD and Plasma TV's in TV wall

### SOUND

MAIN ROOM CORE: 6 x Dynacord Alpha Concept X-1/90 speaker; 6 x Dynacord Alpha Concept B-3 speaker; 6 x Electro-Voice 1200RL digitally controlled amp; 6 x Electro-Voice P3000RL digitally controlled amp. VIP LOUNGE: 4 x EAW JFX100 2-way full range loudspeaker; 6 x EAW SB48e low frequency speaker system; 4 x Electro-Voice P2000. LUNAR CAVE BAR: 4 x EAW JFX100; 2 x EAW SB250P; 1 x Electro-Voice P2000 amp; 1 x Electro-Voice P3000 amp; 1 x I.A.S. IP2 input panel with NEUTRIK connectors. BAR: 4 x EAW JFX100; 2 x EAW SB250P subwoofer; 1 x Electro-Voice P2000; 1 x EV P3000 amp

MEZZANINE BALCONY: 2 x DYNACORD V-1/90 CM-F 3-way; 1 x Electro-Voice P1200RL digitally controlled amp; 1 x Electro-Voice P3000RL digitally controlled amp; 1 x I.A.S. IP2; 1 x Mystery Electronics FMCA28RK floor box; 1 x Mystery Electronics BB2000. OUTDOOR DECK AND UNDER DECK: 6 x EAW-UB82-WP/W 2-way full range system; 2 x EAW SB250P-WP; 1 x Electro-Voice P2000 amp; 3 x Electro-Voice P3000 amp; 1 x I.A.S. IP2 panel. DJ / CONTROL BOOTH: 2 x ELECTRO VOICE X-1152A/64F Two-way, full range speaker system; 1 x Electro-Voice QRX218-S Very Low Frequency System; 1 x Electro-Voice P1200RL digitally controlled amp; 1 x Electro-Voice P3000RL digitally controlled amp; 1 x BIAMP Systems Audia VS8; 500 x GEPCO UNC-220; 3 x Pioneer CDJ-1000MKII; 3 x Technics SL-1210M5G; 4 x EAW JFX100 loudspeaker. ESCALATOR LANDINGS: 2 x EAW JFX88; 1 x Electro-Voice P1200; 1 x DSP and rack room core; 1 x BIAMP Audiaflex NC; 4 x BIAMP Audia IP-2; 8 x BIAMP Audia OP-2; 1 x BIAMP Logic box; 1 x Furman PL8 Series II; 3 x Lowell Manufacturing L278-77; 1 x Lowell Manufacturing L278-77SP; 3 x Lowell Manufacturing L35-1912; 3 x Mystery Electronics FMCA120R floor box

[www.n9negroup.com](http://www.n9negroup.com)

planning and designer collaboration required to ensure a perfect finished article. This long gestation period allowed the design to evolve along the way as new technologies became available. "Originally the club wasn't going to be a very video-centric project," N9NE group's technical director Adam Wuertz recalls. "Then during the process of development, the DL2 came out and suddenly we had the ability to include not just video, but moving video. A lot of things in the club were tweaked a little this way or that way to help better utilize the capabilities of that fixture." Chief among these were the silver-beaded curtains that cover the Moon's panoramic windows. They fulfill the dual role of helping to distinguish the club from its neighbour, Ghostbar (which also features a 270° view), whilst also providing an extra surface onto which the LD can project.

In addition to the DL2s, Wuertz specified an entirely Martin Professional rig. "I haven't found any fixtures to compete with the Martin club line," he remarks. "There's nothing else with

that speed of movement combined with such a high output light source." Sixteen MX-10 Extremes, two Atomic 3000 strobes and four Club smoke systems are spread round the periphery of the room, but when it came to the dancefloor, the retractable roof posed something of an obstacle. "As amazing and wonderful as having the roof is, it leads to one giant problem if you want to install any lights over the dancefloor," Wuertz continues. "And as anyone who knows anything about club lighting will tell you, the workhorse of your rig is going to be whatever is directly above the dancefloor."

To avoid having a lot of truss dominating the room, the team settled on the idea of six I-beams jutting out of the fixed ceiling, each with track system that would allow extra lights to be extended eight feet over the edge of the dancefloor.

"We approached Tomcat in Texas as they're pretty much genius at doing anything: if you give them an idea, they just run with it," says Adam Gregory of lighting and video installer, ►



Clockwise from above: the outdoor patio area offers unrivalled views of the Las Vegas skyline; Dynacord Alpha speakers act as an added projection screen for the eight DL2s; Dynacord concept subs

►Kelley Technologies. "They're very smart about how they do their structure and the mechanics – so we gave them the concept and the weight that needed to be moved and they came up with these brilliant extending arms." Each track carries four fixtures (MAC250 Kryptons and MAC300 Washes). Together they add an extra element to the lighting designer's toolbox. The trussing concept was originally developed by Steve Cox of Kelley Technologies – he sadly died before the club construction got underway, but his daring use of flame and lightning effects in clubs like Rain made him a pioneer in club installation. "He had a knack of looking at a room and doing something extra with it – not just the run of the mill stuff" remembers Gregory. The main room effects are completed by three lasers installed by Doug Adams of Laser Design Productions. The centerpiece of these is a full-colour 3.5 watt Coherent white light laser with ceramic tube. The projector was custom designed for Moon and is operated with the help of Pangolin laser control PC boards. To provide the audio system, the N9NE group bought in long-time collaborator Infinite Audio. Wuertz worked closely with Infinite's Lord Touissant and David Sullivan to ensure the design was both functional and aesthetically attractive. Far from hiding the speakers away, they opted for an imposing Dynacord Alpha system – something of an Infinite Audio signature-product (not surprising given it was Sullivan who originally helped Matthias von Hydekamp introduce the brand to the US). Six Alphas loom over the dancefloor; their expansive silver-grey grills providing another projection surface for the DL2s. The original idea was to fly them over the dancefloor, but as Touissant pointed out, this would have left lots of unsightly cables hanging from the ceiling. Instead most of the weight is supported on silver poles leading up from the two narrow catwalks used by the dancers that appear at ►

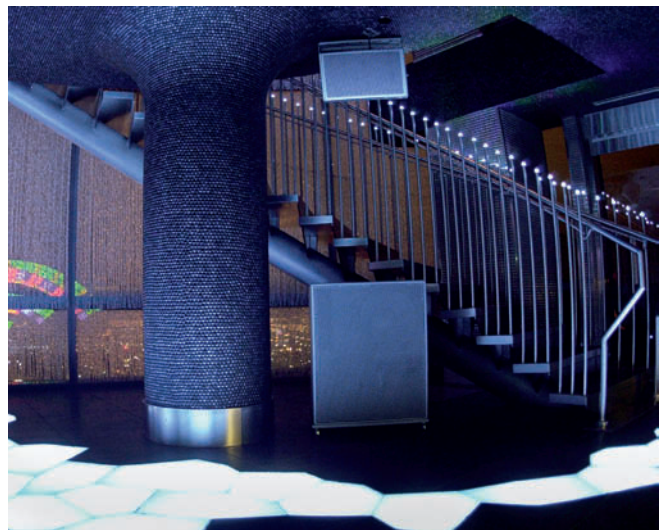
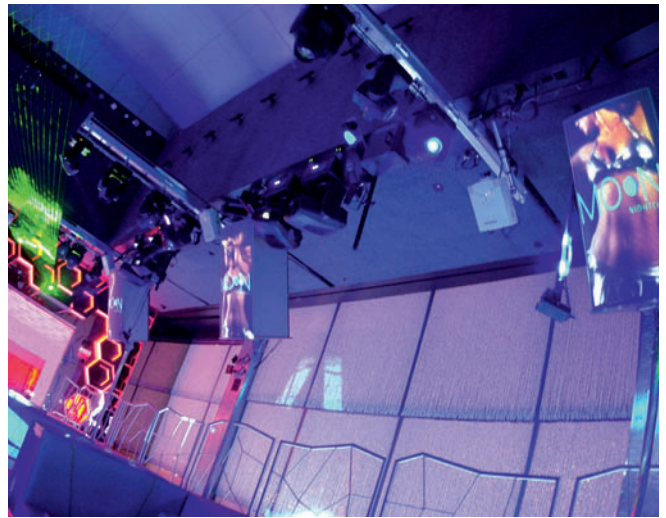

► various points throughout the night. These poles conceal all the necessary cabling and provide additional support for the dance-routines. Safety wires take the rest of the speakers' weight and guard against any potential seismic activity. With floor space at a premium, Alpha concept subs were integrated in to the side of the seating booths and underneath the catwalk.

"We tried to create an energy throughout the entire property so that, as you move through the rooms, you get the same dynamic sound – even on the patios outside where we used EAW weather protected products," says Sullivan. Further EAW products were used as under-balcony fills in the main room as well as in the VIP room. Infinite took on lighting duties in this VIP area, which combines E:cue controlled Color Kinetics, TES and Anolis architectural LED fixtures.

From the Moon club, guests can take a glass walled escalator down to the Playboy club on the floor below. This modern take on Hugh Hefner's world-famous brand is described by DeGraff as "a mansion in the sky...comprised of the most exotic materials, complemented by high-tech special effects and, of course, the most beautiful women in the world." It mixes a sleek seventies style with some very clever technology. Usually a club's ultimate concern is the safe and efficient sale of alcohol. Playboy though is predominantly a gaming room – a fact that required a special dispensation from the state's gaming commission (casino's are not usually allowed to charge entry as Playboy and Moon do). There were a whole range of factors that had to be considered: what can and can't be displayed on video screens, the audibility of players and croupiers and the level of light that must be thrown on to each gaming table for security purposes. As a result, the room required a particularly high level of lighting audio control. To meet this challenge Infinite used a Biamp Audia system. A video wall, designed by James Geier of 555 in Chicago and installed by Kelley's Nevin Edwards, acts as one of the clubs main features, for which a Crestron control system was used.

The Palms have always had their finger on the pulse of Vegas life and it seems this latest collaboration with the N9NE group – a complimentary mix of Playboy's super lounge and Moon's high-energy club - has once again pushed the technology envelope, setting the standard for others to follow. ■



The video wall in the Playboy club



Electro-Voice amps are on display behind glass cases

FRANÇAIS

Le Moon Club occupe l'étage supérieur de la nouvelle Fantasy Tower de l'hôtel Palms. Son plancher est revêtu de carreaux de verre miroitants qui, par le biais d'un système d'éclairage commandé par ordinateur, changent de couleur lorsque les clients se déplacent dessus. Un rideau de perles de verre est suspendu aux fenêtres à hauteur intégrale d'où l'on a une vue imprenable sur Las Vegas du club de 1160 mètres carrés. La salle principale du club est surmonté d'un immense toit escamotable, qui s'ouvre pour offrir une vue stupéfiante sur le ciel étoilé. Lorsqu'il est fermé, le plafond sert d'écran pour les huit projecteurs High End DL2. En outre, un groupe d'éclairage réalisé en grande partie par Martin Professional a été mis en place par l'entreprise Kelley Technologies de Las Vegas, avec une installation supplémentaire à laser produite par Laser Design Productions. La piste de danse est surplombée par d'immenses haut-parleurs Dynacord Alpha, installés par Infinite Audio, offrant des surfaces de projection additionnelles. Le renforcement du son dans le salon VIP et sur les balcons extérieurs est assuré par EAW. En bas se trouve le Playboy Club, une salle de jeu dans le style des années soixante-dix, à laquelle on accède par un ascenseur à vitres et miroirs.

DEUTSCH

Der Moon Club befindet sich im obersten Stock des neuen Fantasy Tower im Hotel Palm's. Den Boden des ca. 1100 Quadratmeter großen Clubs bilden schimmernde Glasfliesen in den unterschiedlichsten Formen und Größen, die durch ein computergesteuertes Beleuchtungssystem bei Bewegung der Gäste die Farbe wechseln. Ein Glasperlenvorhang ziert die Fenster, die sich bei der gesamten Raumhöhe erstrecken und einen fantastischen Blick auf den Las Vegas trip bieten. Der Hauptraum hat ein riesiges, bewegliches Dach, das bei Öffnung einen fantastischen Blick auf den Sternenhimmel freigibt. Im geschlossenen Zustand fungiert die Decke als Projektionsfläche für die acht DL2-Digitalprojektoren von High End. Für die Installation des von Martin Professional dominierten Beleuchtungsrigs zeichnete die Firma Kelley Technologies aus Las Vegas verantwortlich. Laser Design Productions steuerte weitere Laserinstallationen bei. Riesige Dynacord Alpha-Lautsprecher (Installation: Infinite Audio) über der Tanzfläche fungieren als zusätzliche Projektionsflächen, und EAW sorgt für weitere Soundverstärkung in der VIP-Lounge und auf den äußeren Balkonen. Eine Etage tiefer befindet sich der Playboy Club, eine Gambling-Lounge im Stil der 70er Jahre, die vom Moon aus über einen verspiegelten Glasaufzug zu erreichen ist.

ITALIANO

Il Moon Club occupa l'ultimo piano della nuova Fantasy Tower dell'hotel Palms. Il pavimento del Moon (che vanta una superficie di 1.160 metri quadri) è ricoperto di scintillanti piastrelle di vetro i varie forme e dimensioni, che cambiano colore tramite un sistema d'illuminazione computerizzato che si attiva al passaggio degli ospiti. Un tendaggio di perline di vetro protegge le finestre a tutta altezza, che offrono viste incredibili sullo 'Strip' di Las Vegas. La sala principale del locale è dotata di un enorme tetto retrattile, che può essere aperto per rivelare il firmamento. Quando è chiuso, il soffitto riveste la funzione di schermo per gli otto proiettori digitali High End DL2. Un rig con luci principalmente di Martin Professional è stato installato da Kelley Technologies, una società con sede a Las Vegas, mentre le luci laser sono a cura di Laser Design Productions. Enormi diffusori Dynacord Alpha, installati da Infinite Audio, torreggiano sulla pista da ballo e offrono ulteriori superfici di proiezione. L'impianto della sezione VIP e del balcone esterno comprende prodotti EAW. Al piano di sotto si trova il Playboy Club, una lounge dedicata al gioco d'azzardo che può essere raggiunta in vetro e specchi dal Moon Club.

ESPAÑOL

Moon Club ocupa la planta superior de la nueva Fantasy Tower, en el hotel Palms. El suelo de Moon está cubierto con baldosas de cristal brillante de distintas formas y tamaños que cambian de color gracias a un sistema informatizado de iluminación a medida que los clientes van pasando por ellas. Una cortina de cuentas de cristal cuelga de las ventanas, que van del techo al suelo y dotan al club, de más de 3.600 metros cuadrados, de unas vistas increíbles de Las Vegas. La sala principal del local cuenta con un imponente techo retráctil que se abre para ofrecer una vista fantástica de las estrellas. Cerrado, sirve de pantalla para ocho proyectores digitales High End DL2. Kelley Technology, de Las Vegas, instaló un sistema de iluminación, predominantemente de Martin Professional, con un sistema láser adicional de Laser Design Productions. Unos enormes altavoces Dynacord Alpha instalados por Infinite Audio dominan la pista de baile y ofrecen superficies extra de proyección. El refuerzo de audio adicional de la sala VIP y en el balcón exterior es cortesía de EAW. Abajo encontramos el Playboy Club, una sala de juego al estilo de los setenta a la que puede accederse desde Moon a través de unas escaleras mecánicas de cristal y espejo.